

CERTIFIED LAND CORNER RECORDATION

DESCRIPTION OF CORNER EVIDENCE FOUND, AND ORIGINAL RECORD (If known)

34	35	T.14 N.,	R.68 W., 6 th P.M., Laramie County, Wyoming
3	2	T.13 N.	

Found 12"x6"x12" hard granite stone with plainly visible marks: 2 on east and 4 on west. Stone is well set.

DESCRIPTION OF MONUMENT AND ACCESSORIES ESTABLISHED TO PERPETUATE THE ORIGINAL LOCATION OF THIS CORNER:

References: 1/2" x 18" iron pipe northerly and westerly.

SKETCH, WITH COURSE AND DISTANCE TO ADJACENT CORNER IF DETERMINED IN THIS SURVEY.
(May Sketch or Paste Reproduction on Reverse Side.)

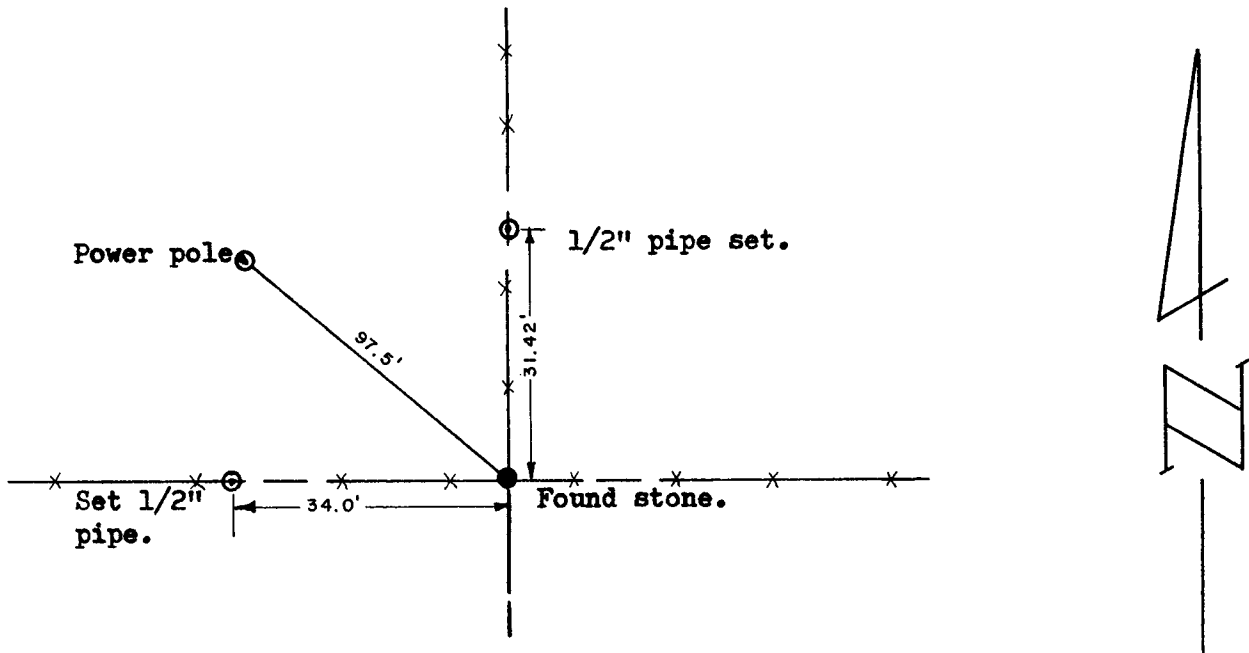

I, William D. Braman certify that I have carefully performed or reviewed the work done on the diagrammed corner as reported on this recordation form and approve the same.

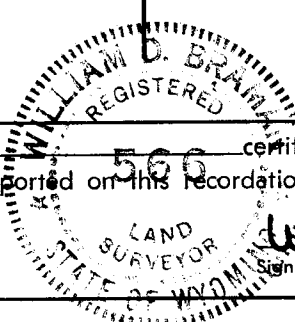

William D. Braman Signature of Surveyor LS 566 Registration No.

STATE OF WYOMING,
Office of Clerk and Recorder,
County of Laramie

This "corner record" was filed for record on the 18 day of Feb., 1977, was noted on the cross-index plat and is assigned page No. _____, in book No. _____.

Janet C. Whitehead
County Official

Cross Index No. <u>217</u>	T. <u>14</u>	R. <u>68</u>	Mer.
<u>A 17</u>	T. <u>13</u>	R. <u>68</u>	Mer.
_____	T. _____	R. _____	Mer.
_____	T. _____	R. _____	Mer.
_____	T. _____	R. _____	Mer.
_____	T. _____	R. _____	Mer.